



Beachten Sie im Zusammenhang mit diesem Datenblatt auch  
 Katalog **PRT2**  
 34-36

## Nr. 11 „Mix & Match“ – Kombinationsmöglichkeiten

HepcoMotion® PRT2 Produkte sind miteinander kombinierbar und bieten so eine optimierte und flexible Produktpalette. Die unten stehenden Tabellen zeigen, welche Elemente zusammen verwendet bzw. nicht zusammen verwendet werden können. Falls Sie Beratung benötigen oder einen speziellen Anwendungsfall diskutieren möchten, setzen Sie sich bitte mit der technischen Abteilung von Hepco in Verbindung.

- ✓ Bevorzugte Wahl
- ✓ Kompatibel
- \* Nicht Kompatibel

Lager

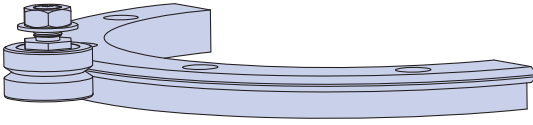
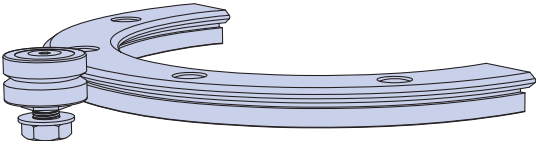

Lager	Ringe/Segmente mit doppelter V-Führung	Einseitige V-Führung außen												Einseitige V-Führung innen				Ringscheiben																	
		(T)R1293	(T)R12127	(T)R20143	(T)R20210	(T)R25159	(T)R25255	(T)R25351	(T)R44468	(T)R44612	(T)R76799	(T)R761033	(T)R761267	(T)R761501	REV156	REV223	RES184	RES280	(T)RES376	REM505	(T)REM655	REL874	RIV161	RIV228	RIS182	(T)RIS278	RIS374	(T)RIM482	RIM627	RIL820	RD25159	RD25255	RD25351	RD44468	
...J13...	✓	✓	✓	✓	✓	✓	✓	✓	✓	✓	✓	✓	✓	✓	✓	✓	✓	✓	✓	✓	✓	✓	✓	✓	✓	✓	✓	✓	✓	✓	✓	✓	✓	✓	✓
...J18...	✓	✓	✓	✓	✓	✓	✓	✓	✓	✓	✓	✓	✓	✓	✓	✓	✓	✓	✓	✓	✓	✓	✓	✓	✓	✓	✓	✓	✓	✓	✓	✓	✓	✓	✓
...J25...	* x	* x	✓	✓	✓	✓	✓	✓	✓	✓	✓	✓	✓	✓	✓	✓	✓	✓	✓	✓	✓	✓	✓	✓	✓	✓	✓	✓	✓	✓	✓	✓	✓	✓	✓
...J34...	* x	* x	✓	✓	✓	✓	✓	✓	✓	✓	✓	✓	✓	✓	✓	✓	✓	✓	✓	✓	✓	✓	✓	✓	✓	✓	✓	✓	✓	✓	✓	✓	✓	✓	✓
...J54...	* x	* x	* x	* x	* x	* x	* x	✓	✓	✓	✓	✓	✓	* x	* x	* x	* x	* x	✓	✓	✓	✓	* x	* x	* x	* x	✓	✓	✓	✓	✓	* x	* x	* x	✓

Lager mit Axialausgleich

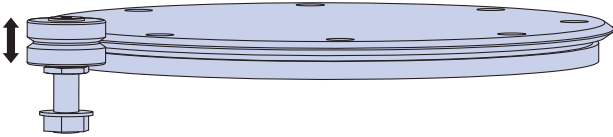
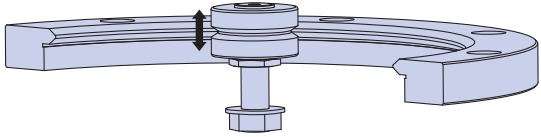

Lager mit Axialausgleich	Ringe/Segmente mit doppelter V-Führung	Einseitige V-Führung außen												Einseitige V-Führung innen				Ringscheiben																		
		(T)R1293	(T)R12127	(T)R20143	(T)R20210	(T)R25159	(T)R25255	(T)R25351	(T)R44468	(T)R44612	(T)R76799	(T)R761033	(T)R761267	(T)R761501	REV156	REV223	RES184	RES280	(T)RES376	REM505	(T)REM655	REL874	RIV161	RIV228	RIS182	(T)RIS278	RIS374	(T)RIM482	RIM627	RIL820	RD25159	RD25255	RD25351	RD44468		
...FJ25...	* x	* x	✓	✓	✓	✓	✓	✓	✓	✓	✓	✓	✓	✓	✓	✓	✓	✓	✓	✓	✓	✓	✓	✓	✓	✓	✓	✓	✓	✓	✓	✓	✓	✓	✓	
...FJ34...	* x	* x	✓	✓	✓	✓	✓	✓	✓	✓	✓	✓	✓	✓	✓	✓	✓	✓	✓	✓	✓	✓	✓	✓	✓	✓	✓	✓	✓	✓	✓	✓	✓	✓	✓	✓
...FJ54...	* x	* x	* x	* x	* x	* x	* x	✓	✓	✓	✓	✓	✓	* x	* x	* x	* x	* x	✓	✓	✓	✓	* x	* x	* x	* x	✓	✓	✓	✓	✓	* x	* x	* x	✓	

# Nr. 11 „Mix & Match“

## Schmierblöcke

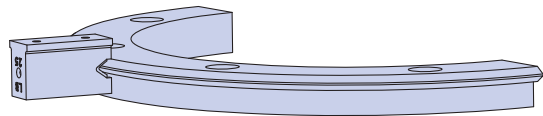
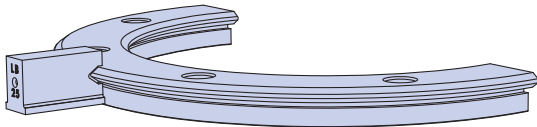

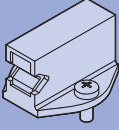
	Ringe/Segmente mit doppelter V-Führung											Einseitige V-Führung außen						Einseitige V-Führung innen						Ringscheiben								
	(T)R1293	(T)R12127	(T)R20143	(T)R20210	(T)R25159	(T)R25255	(T)R25351	(T)R44468	(T)R44612	(T)R76799	(T)R761033	(T)R761267	(T)R761501	REV156	REV223	RES184	RES280	(T)RES376	REM505	(T)REM655	REL874	RIV161	RIV228	RIS182	(T)RIS278	RIS374	(T)RIM482	RIM627	RIL820	RD25159	RD25255	RD25351
Schmierblöcke	LB12	✓	✓	✓	✓	✓	✓	✗	✗	✗	✗	✗	✗	✓	✓	✓	✓	✓	✗	✗	✗	✓	✓	✓	✗	✗	✗	✗	✓	✓	✓	✗
	LB20	✗	✗	✓	✓	✓	✓	✓	✓	✗	✗	✗	✗	✓	✓	✓	✓	✓	✓	✗	✓	✓	✓	✓	✗	✗	✗	✗	✓	✓	✓	✓
	LB25	✗	✗	✗	✗	✓	✓	✓	✗	✗	✗	✗	✗	✗	✗	✓	✓	✓	✗	✗	✗	✓	✓	✓	✗	✗	✗	✗	✓	✓	✓	✗
	LB44	✗	✗	✗	✗	✗	✗	✓	✓	✗	✗	✗	✗	✗	✗	✗	✗	✓	✓	✗	✗	✗	✗	✗	✓	✓	✗	✗	✗	✗	✗	✓
	LB76	✗	✗	✗	✗	✗	✗	✗	✗	✓	✓	✓	✓	✗	✗	✗	✗	✗	✗	✓	✓	✗	✗	✗	✗	✗	✓	✗	✗	✗	✗	✗

## Ritzel

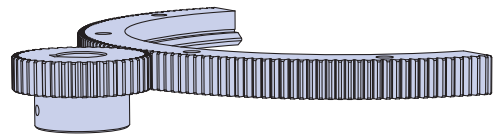
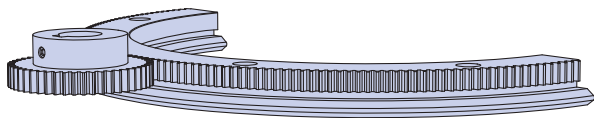

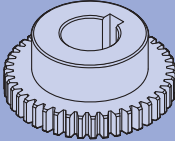
	Ringe/Segmente mit doppelter V-Führung											Einseitige V-Führung außen						Einseitige V-Führung innen						Ringscheiben									
	(T)R1293	(T)R12127	(T)R20143	(T)R20210	(T)R25159	(T)R25255	(T)R25351	(T)R44468	(T)R44612	(T)R76799	(T)R761033	(T)R761267	(T)R761501	REV156	REV223	RES184	RES280	(T)RES376	REM505	(T)REM655	REL874	RIV161	RIV228	RIS182	(T)RIS278	RIS374	(T)RIM482	RIM627	RIL820	RD25159	RD25255	RD25351	RD44468
Ritzel	SSP04W3.5T42	✓	✓	✗	✗	✗	✗	✗	✗	✗	✗	✗	✗	✗	✗	✗	✗	✗	✗	✗	✗	✗	✗	✗	✗	✗	✗	✗	✗	✗	✗	✗	
	SSP07W9T28	✗	✗	✗	✗	✗	✗	✗	✗	✗	✗	✗	✗	✓	✓	✗	✗	✗	✗	✗	✗	✓	✓	✗	✗	✗	✗	✗	✗	✗	✗	✗	✗
	SSP08W4T48	✗	✗	✓	✓	✓	✓	✗	✗	✗	✗	✗	✗	✗	✗	✗	✗	✗	✗	✗	✗	✗	✗	✗	✗	✗	✗	✗	✓	✓	✓	✗	
	SSP08W6T48	✗	✗	✓	✓	✓	✓	✗	✗	✗	✗	✗	✗	✗	✗	✗	✗	✗	✗	✗	✗	✗	✗	✗	✗	✗	✗	✓	✓	✓	✗		
	P10W11T42	✗	✗	✗	✗	✗	✗	✓	✓	✗	✗	✗	✗	✗	✗	✓	✓	✓	✗	✗	✗	✗	✓	✓	✓	✗	✗	✗	✗	✗	✗	✗	
	P10W7T48	✗	✗	✗	✗	✗	✗	✓	✓	✗	✗	✗	✗	✗	✗	✓	✓	✓	✗	✗	✗	✗	✓	✓	✓	✗	✗	✗	✗	✗	✗	✓	
	P125W14T34	✗	✗	✗	✗	✗	✗	✗	✗	✗	✗	✗	✗	✗	✗	✗	✗	✓	✓	✗	✗	✗	✗	✗	✓	✓	✗	✗	✗	✗	✗	✗	
	P15W12T48	✗	✗	✗	✗	✗	✗	✗	✗	✓	✓	✓	✓	✗	✗	✗	✗	✗	✗	✗	✗	✗	✗	✗	✗	✗	✗	✗	✗	✗	✗	✗	
	P20W20T27	✗	✗	✗	✗	✗	✗	✗	✗	✗	✗	✗	✗	✗	✗	✗	✗	✗	✗	✓	✓	✗	✗	✗	✗	✗	✓	✗	✗	✗	✗	✗	

## Laufwagen mit Drehschemeln

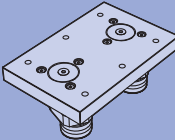
	Ringe/Segmente mit doppelter V-Führung												
	(T)R1293	(T)R12127	(T)R20143	(T)R20210	(T)R25159	(T)R25255	(T)R25351	(T)R44468	(T)R44612	(T)R76799	(T)R761033	(T)R761267	(T)R761501
Laufwagen mit Drehschemeln	BCP25	✗	✗	✗	✓	✓	✓	✗	✗	✗	✗	✗	✗
	BCP44	✗	✗	✗	✗	✗	✓	✓	✗	✗	✗	✗	✗
	BCP76	✗	✗	✗	✗	✗	✗	✗	✓	✓	✓	✓	✓

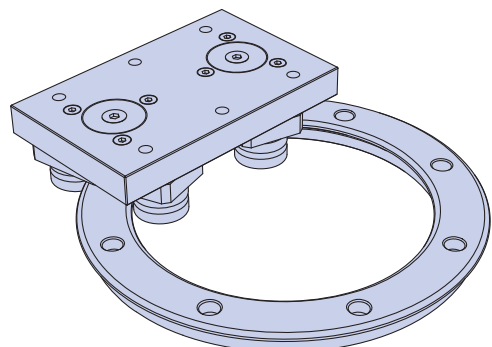

# Nr. 11 „Mix & Match“

Führungsschienen für Schienensysteme

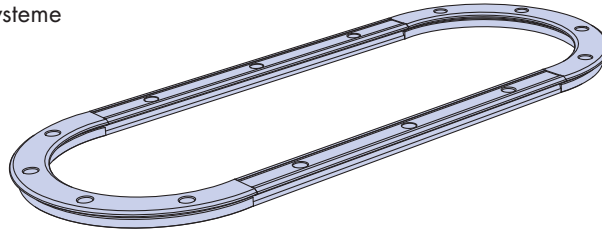

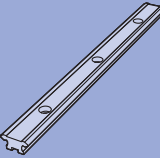
	Ringe/Segmente mit doppelter V-Führung													Einseitige V-Führung außen				Einseitige V-Führung innen				Ringscheiben														
	(T)R1293	(T)R12127	(T)R20143	(T)R20210	(T)R25159	(T)R25255	(T)R25351	(T)R44468	(T)R44612	(T)R76799	(T)R761033	(T)R761267	(T)R761501	REV156	REV223	RES184	RES280	(T)RES376	REM505	(T)REM655	REL874	RIV161	RIV228	RIS182	(T)RIS278	RIS374	(T)RIM482	RIM627	RIL820	RD25159	RD25255	RD25351	RD44468			
Führungsschienen für Schienensysteme	TNMS12	✓	✓	x	x	x	x	x	x	x	x	x	x	x	x	x	x	x	x	x	x	x	x	x	x	x	x	x	x	x	x	x	x	x	x	
	TNV20	x	x	✓	✓	x	x	x	x	x	x	x	x	x	x	x	x	x	x	x	x	x	x	x	x	x	x	x	x	x	x	x	x	x	x	
	TNS25	x	x	x	x	✓	✓	✓	x	x	x	x	x	x	x	x	x	x	x	x	x	x	x	x	x	x	x	x	x	x	x	x	x	x	x	
	TNM44	x	x	x	x	x	x	x	✓	✓	x	x	x	x	x	x	x	x	x	x	x	x	x	x	x	x	x	x	x	x	x	x	x	x	x	
	TNL76	x	x	x	x	x	x	x	x	x	✓	✓	✓	✓	x	x	x	x	x	x	x	x	x	x	x	x	x	x	x	x	x	x	x	x	x	x
	TNSE	x	x	x	x	x	x	x	x	x	x	x	x	x	x	x	x	✓	x	x	x	x	x	x	✓	x	x	x	x	x	x	x	x	x	x	x
	TNME	x	x	x	x	x	x	x	x	x	x	x	x	x	x	x	x	x	x	✓	x	x	x	x	✓	x	x	x	x	x	x	x	x	x	x	x

Laufwagen mit fester Lageranordnung

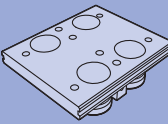
	Ringe/Segmente mit doppelter V-Führung												
	(T)R1293	(T)R12127	(T)R20143	(T)R20210	(T)R25159	(T)R25255	(T)R25351	(T)R44468	(T)R44612	(T)R76799	(T)R761033	(T)R761267	(T)R761501
Laufwagen mit fester Lageranordnung*	FCC1293	✓	x	x	x	x	x	x	x	x	x	x	x
	FCC12127	x	✓	x	x	x	x	x	x	x	x	x	x
	FCC20143	x	x	✓	x	x	x	x	x	x	x	x	x
	FCC20210	x	x	x	✓	x	x	x	x	x	x	x	x
	FCC25159	x	x	x	x	✓	x	x	x	x	x	x	x
	FCC25255	x	x	x	x	x	✓	x	x	x	x	x	x
	FCC25351	x	x	x	x	x	x	✓	x	x	x	x	x
	FCC44468	x	x	x	x	x	x	x	✓	x	x	x	x
	FCC44612	x	x	x	x	x	x	x	x	✓	x	x	x
	FCC76799	x	x	x	x	x	x	x	x	x	✓	x	x
	FCC761033	x	x	x	x	x	x	x	x	x	x	✓	x
	FCC761267	x	x	x	x	x	x	x	x	x	x	x	✓
FCC761501	x	x	x	x	x	x	x	x	x	x	x	x	✓



\*Laufwagen mit fester Lageranordnung können nur mit Ringen bzw. Segmenten mit doppelter V-Führung verwendet werden. Für weitere Details zum Gebrauch von Trägerplatten bei einseitiger V-Führung beachten Sie bitte unser Datenblatt Nr. 4 Schienensysteme mit einseitiger V-Führung.

HepcoMotion®, Postfach 1130, D - 90531 Feucht

Tel: +49 (0) 9128/9271-0

Fax: +49 (0) 9128/9271-50

E-mail: info.de@hepcotion.com