

# Linear actuator Kompakt



*Our elegant  
model with  
compact design*



# Linear actuators Kompakt



## Description · Applications

The linear actuators of the Kompakt series are versatile push rod actuators with compact design used mainly for

- Locking devices for rolling doors
- Tilting devices
- Turbine blade adjustment
- Operable windows
- Lifting platforms and many other applications

### The facts

Kompakt	
Load (N)	400-15,000
Stroke speed (mm/s)	1.5-65
Standard stroke length (mm) (stroke length extension up to a max. of 500 mm in intervals of 50 mm)	200
Operating voltage	<b>400 V/3 AC or 24 V/DC</b>
Temperature range (°C)	-10 to +50
Protection type	IP 54
Piston rod	torsion-lock
Double scraper ring	at piston outlet
Limit switch	adjustable, with status signal
Design	extremely short thanks to special elero technology

## Load (N) and stroke speeds (mm/s)

Version	400 V-3 AC 50 Hz Rating: S3 - 15%			24 V DC Rating: S3 - 15%			24 V DC Rating: S1			Number of add. planetary gear stages	Available with brake only
	Stroke speed mm/s	Load N	Nominal current A	Stroke speed mm/s	Load N	Nominal current A	Stroke speed mm/s	Load N	Nominal current A		
A	65	1,000	1.3	55	700	10	-	-	-	-	x
B	45	1,500	1.3	35	1,000	10	-	-	-	-	x
C	17	4,000	1.3	17	1,500	10	22	400	5	-	x
D	12	7,000	1.3	12	2,600	10	15	1,000	5	-	-
E	7	12,000	1.3	7	5,500	10	9.5	1,800	5	-	-
F	5.5	15,000	1.3	4.5	8,000	10	5.5	2,500	5	1	-
G	4	15,000	1.3	3	11,000	10	4	4,500	5	1	-
H	2	15,000	1.3	2	15,000	8	2.5	8,500	5	1	-
I	1.6	15,000	1.3	1.5	15,000	5	1.5	15,000	5	1	-

**Note:** All technical data represent average values and are based on an ambient temperature of 20 °C. Stroke speeds of direct current motors are load and temperature dependent.

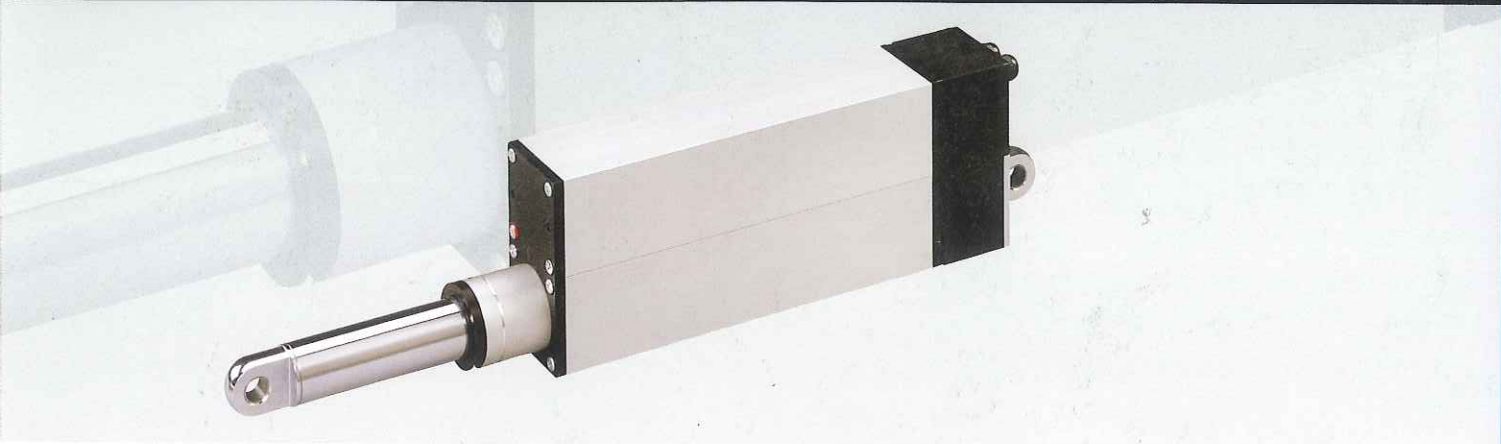

## Options

- Potentiometer for output of a stroke-dependent resistance value
- Encoder
- Brake
- DIN 71752 clevis end G 16 x 32 on piston and/or housing end
- DIN 648 joint rod head GISW 16 on piston and/or housing end
- Spring-action articulated lug on piston end
- Adjustable articulated lug on piston end

Other stroke lengths, special voltages, circuit variants, cable types as well as additional equipment (protective sleeve, recirculating ballscrew, plug connections, etc.) on request.

## Fixing on piston end

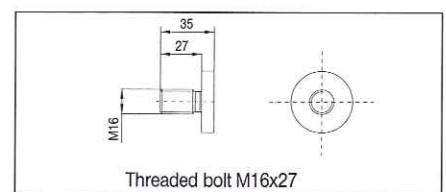
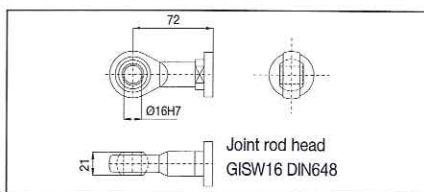
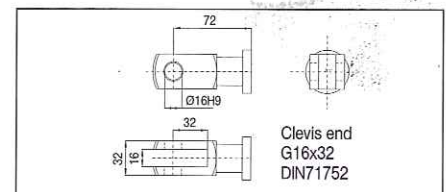
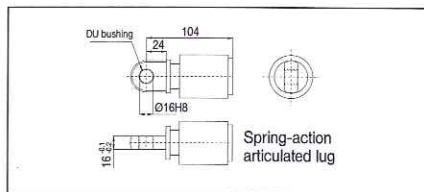
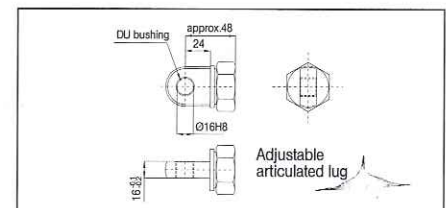
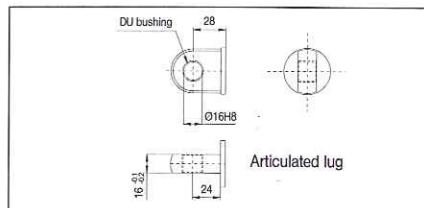

## Fixing on housing end

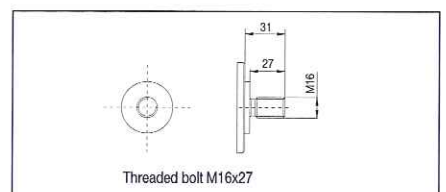
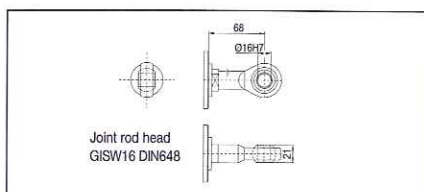
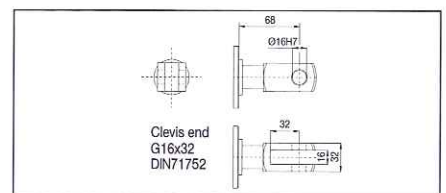
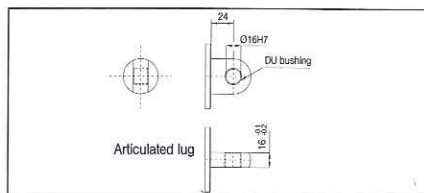

# Technical data and dimensions

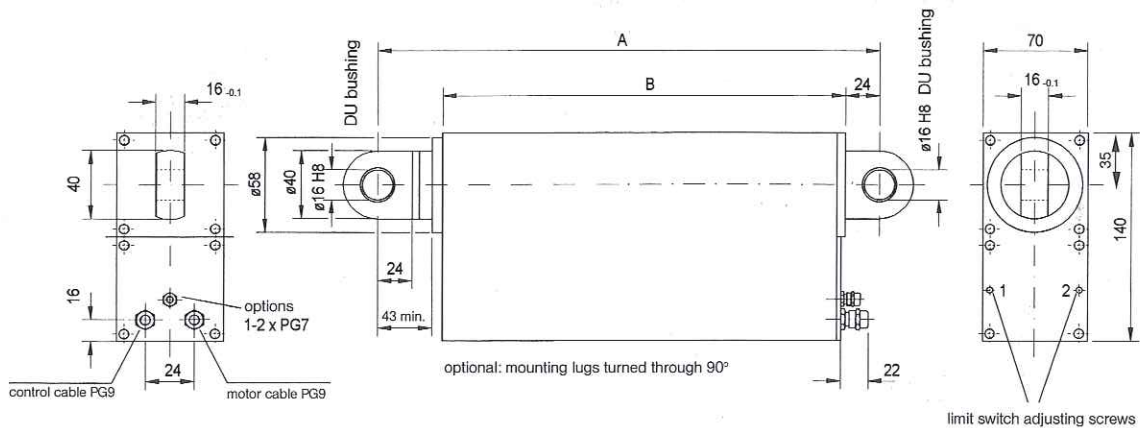

## Dimension A

Stroke length	Dimension A	
	min.	max.
200	450*	650*
250	500	750
300	550	850
350	600	950
400	650	1050
450	700	1150
500	800	1300

Dimension A increases by

- + 44 mm with an attached clevis end/joint rod head
- + 75 mm with an attached spring-action articulated lug

### \*ATTENTION:

If the body dimension is 426 mm, dimension A increases by 50 mm.

## Dimension B

Basic version	376
With additional planetary gear stage and (potentiometer or brake)	426
With brake and potentiometer	426

### elero GmbH

#### Linearantriebstechnik

Nassaeckerstrasse 11

D-07381 Poessneck

Phone +49 (0) 3647 / 46 07-0

Fax Reception +49 (0) 3647 / 46 07-40

Fax Purchasing department -41

Fax Sales department -42

Head office:

Linsenhofer Str. 59-63

D-72660 Beuren

Phone +49 (0) 70 25 / 13-02

Fax Reception +49 (0) 70 25 / 13-212

info@elero-linear.de

www.elero-linear.com