

PDU2 AC Geared Motor

HepcoMotion® has introduced a range of AC worm geared motors to enhance the PDU2 product. These are supplied with a single size of motor and a range of gearbox ratios from 10:1 to 80:1. This provides driving forces to 170N and linear speeds from 0.056 to 0.448 m/s.

This range of AC geared motors complements the already exceptional performance of the PDU2 product, and enhances its compact design. It also provides a very cost effective package especially when compared to stepper or servo motor solutions which are an unnecessary sophistication in many applications. The standard unit offered is protected to IP65 so suits both the standard and corrosion resistant versions of the PDU2. For further details on the PDU2 product please see the full PDU2 profile driven unit catalogue.

PDU2 AC Geared Motor - Standard features

Compact design - Complements PDU2 unit

Simple Connection - Compact tubular flange, with high performance coupling

Simple selection - Just select the required speed, with a suitable linear force

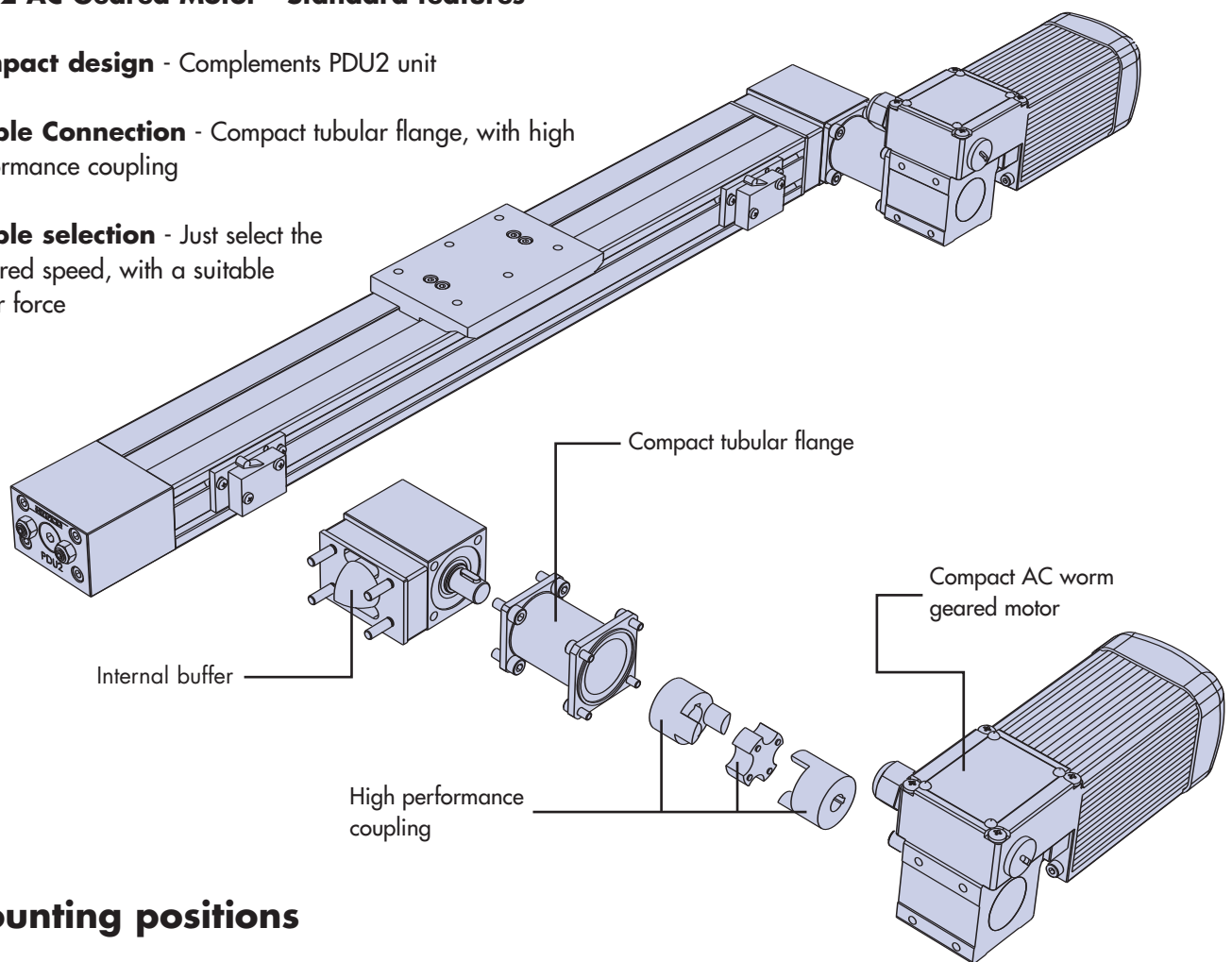

Mounting positions

Right handed

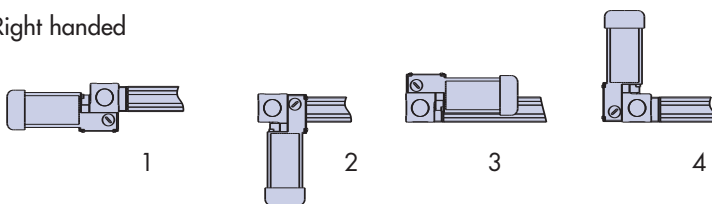

Left handed

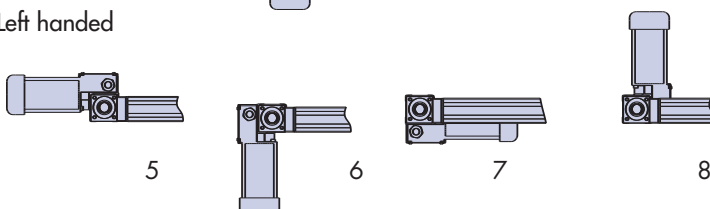

The diagram opposite details the available mounting positions for the AC geared motor when fitted to the PDU2 unit.

Data & Dimensions

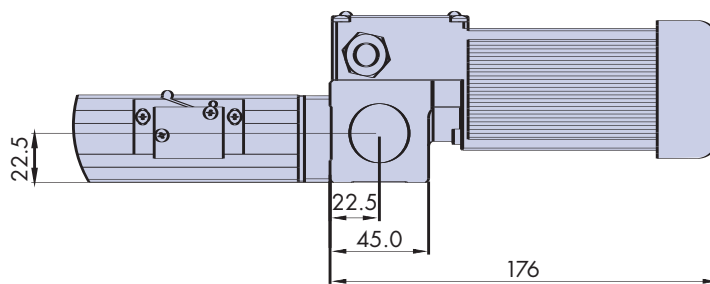
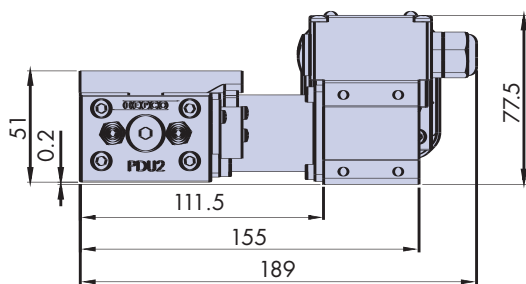

PDU2 AC geared motor shown mounted in position 5.

Nominal Speed m/s at 50Hz	Ratio	Nominal Linear Force N	Part No
0.448	10:1	30	PDU2GMK - 10
0.298	15:1	47	PDU2GMK - 15
0.179	25:1	76	PDU2GMK - 25
0.099	45:1	123	PDU2GMK - 45
0.074	60:1	154	PDU2GMK - 60
0.056	80:1	171	PDU2GMK - 80

Ordering Information

For ease of selection and ordering, these part numbers include the AC geared motor and complete coupling kit. Should just the AC geared motor be required then remove K from the part number.

The PDU2 AC geared motor comes with a 3 phase (240/400V), 2 pole motor, with a rated power of 20W, protected to IP65 as standard. The worm gearbox is available with a range of ratios from 10:1 to 80:1. The unit is lightweight and compact which ideally suits the PDU2 system, (1.53kg). Motors can be controlled via standard inverter drives also available from **HepcoMotion**[®]. With inverter drives, the geared motors will produce the nominal linear force at speeds ranging from 70% to 120% of the nominal linear speed, the units will perform with a lower force and duty cycle over a much wider speed range from 30% to 200% of the nominal speed. 12V and 24V DC motors are available upon request, please contact **HepcoMotion**[®] for details.

HepcoMotion[®], Lower Moor Business Park,
Tiverton Way, Tiverton, Devon, England EX16 6TG

Tel: +44 (0) 1884 257000

Fax: +44 (0) 1884 243500

E-mail: sales@hepcotion.com



INVESTOR IN PEOPLE



HEPCO[®]
www.HepcoMotion.com